

PASSED 6-0

ORDINANCE NO. 337

VILLAGE OF BELLEVUE, ILLINOIS

ORDINANCE GRANTING EASEMENT

WHEREAS, the Pleasant Valley Water District (the "District") has requested that the Village grant an easement to allow construction and repairs of water mains located in Hilltop Road and Crabtree Court in Bellevue; and

WHEREAS, the Village Board of Trustees has determined that the granting of such easement will be in the best interests of the Village and its residents;

NOW, THEREFORE, BE IT ORDAINED BY THE PRESIDENT AND THE BOARD OF TRUSTEES OF THE VILLAGE OF BELLEVUE, PEORIA COUNTY, ILLINOIS, AS FOLLOWS:

Section 1: It is hereby determined that it is advisable, necessary and in the public interest that the Village grant to the Pleasant Valley Water District an easement in the form attached hereto.

Section 2: From and after the effective date of this Ordinance, the President and Clerk are hereby authorized and directed to execute said easement, and to do all things necessary and essential to carry out the terms of said easement.

PASSED AND APPROVED THIS 10th DAY OF JULY, 1989.

Ayes: \_\_\_\_\_

Nays: \_\_\_\_\_

Absent: \_\_\_\_\_

VILLAGE OF BELLEVUE

Larry N. Howard, President

Attest:

Carol S. Howard, Clerk

789-711.A

Document No. \_\_\_\_\_ filed for Record in Recorder's Office of Peoria  
County, Illinois \_\_\_\_\_ at \_\_\_\_\_ o'clock

**EASEMENT** \_\_\_\_\_ Recorder of Deeds

---

---

**EASEMENT**

Now comes the Grantor, THE VILLAGE OF BELLEVUE, and, in exchange for One Dollar and other good and valuable consideration in hand received, does hereby CONVEY and GRANT unto THE PLEASANT VALLEY PUBLIC WATER DISTRICT, as Grantee, an easement in regards to certain property to be used in accordance with the terms and conditions hereinafter set forth, with said property being described as follows:

Part of the East Half of the Northeast Quarter of Section 11, Township 8 North, Range 7 East, in Peoria County, Illinois, generally described as that area within the right of way of Hilltop Road and Crabtree Court, generally commencing at a point on a line extended westerly from the northerly line of High Orchard Place, within the right of way of Hilltop Road, then extending southerly to Crabtree Court, then extending easterly along the full length of Crabtree Court

Said easement shall be used and maintained in accordance with the following terms and conditions:

1. The duration of the Easement shall be perpetual.
2. The Easement shall be used for the purpose of installation and maintenance of a water main and other related materials and equipment.
3. The Grantee shall be permitted unrestricted access to the Easement for installation, maintenance, and repair of said water main and related equipment.
4. The Grantee shall be responsible for any damage caused by the Grantee to properties of the Grantor adjoining the Easement, and covenants to reimburse the Grantor for such damages or restore said property, as close as reasonably possible, to the condition in which said property existed prior to being damaged.

In witness whereof we have placed our hands and seals this \_\_\_\_\_  
day of \_\_\_\_\_, 1989.

VILLAGE OF BELLEVUE

By \_\_\_\_\_  
Its \_\_\_\_\_

ATTEST:

\_\_\_\_\_  
Its \_\_\_\_\_

STATE OF ILLINOIS )  
County of Peoria ) ss.

The foregoing instrument was acknowledged before me this \_\_\_\_\_ day of \_\_\_\_\_, 1989, by \_\_\_\_\_, as \_\_\_\_\_ and by \_\_\_\_\_, as Secretary of the Village of Bellevue, who affixed the seal of said Village all on behalf of the Village of Bellevue.

---

Notary Public

This Instrument Prepared By: Charles M. Rock  
Attorney at Law  
Return to: 530 Peoria Savings Plaza  
Peoria, Illinois 61602

POINT OF NEW CONNECTION



|    |    |    |              |    |    |    |    |           |    |
|----|----|----|--------------|----|----|----|----|-----------|----|
|    |    |    |              |    |    |    |    | HILLCREST |    |
| 1  | 2  | 3  | 4            | 5  | 6  | 7  | 8  | 9         | 10 |
|    |    |    | HIGH ORCHARD |    |    |    |    |           |    |
|    |    |    |              |    |    |    |    | CRABTREE  |    |
| 32 | 33 | 34 | 31           | 30 | 29 | 28 | 27 | 26        | 25 |

NOTE:  
 WATER MAIN TO BE CONSTRUCTED TO PLEASANT VALLEY  
 WATER DISTRICT SPECIFICATIONS.

STATE OF ILLINOIS }  
 COUNTY OF PEORIA } ss

We the ASSOCIATED ENGINEERS, INC., do hereby certify that we have \_\_\_\_\_

and that the above plat is a true and correct representation of said survey as drawn to a scale of 1" equals \_\_\_\_\_  
 Dated this \_\_\_\_\_ day of \_\_\_\_\_ A.D. 19 \_\_\_\_\_

ASSOCIATED ENGINEERS, I

By \_\_\_\_\_  
 Illinois Land Surveyor # \_\_\_\_\_

PLACE

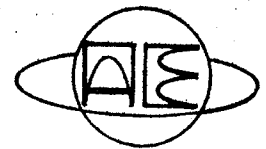
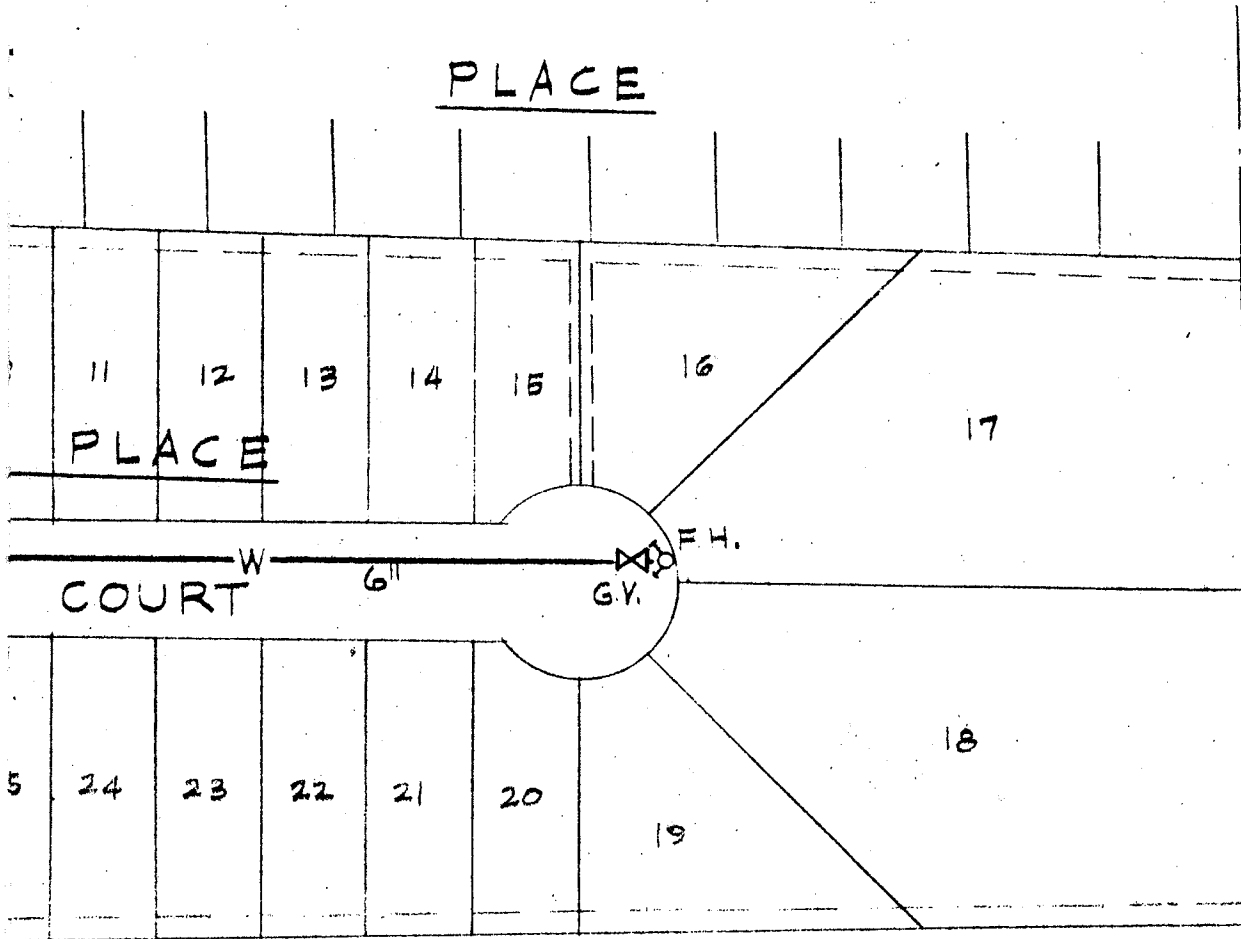

0 100' 200'  
SCALE 1" = 100'

|  |   |
|--|---|
| PLEASANT VALLEY WATER DISTRICT             |   |
| HIGH ORCHARD PLACE<br>WATER MAIN EXTENSION |   |
| DATE<br>6-18-71                            | ASSOCIATED ENGINEERS, INC<br>ELECT. - CIVIL - MECH. - STRUCT. - SURVEYORS<br>505 W. NEBRASKA AVE. - PEORIA, ILLINOIS<br>61604 Phone Code 309-688-3424 |
| DRAWN BY<br>S.V.F.                         |   |
| SURVEY BY                                  |   |
| CHKED. BY                                  |   |

ASSOCIATED ENGINEERS JOB NO.

feet.  
NC.,