

ORDINANCE NO. 556

VILLAGE OF BELLEVUE, ILLINOIS

AN ORDINANCE PROVIDING FOR ANNEXATION OF
CERTAIN TERRITORY TO THE VILLAGE OF BELLEVUE, ILLINOIS
(KNIGHT)

WHEREAS, a petition signed and verified by Gale Gene Knight ("the "Owner") has been filed with the Village Clerk pursuant to and in conformance with Section 7-1-8 of the Illinois Municipal Code, requesting annexation to this Village of that tract of land substantially described therein; and

WHEREAS, it appears that the Owner constitutes the owner of record of this tract of land, and that no electors (other than Petitioner) reside in said tract; that said tract of land is not within the corporate limits of any municipality; and that it is contiguous to the present corporate limits of the Village of Bellevue;

NOW, THEREFORE, BE IT ORDAINED BY THE PRESIDENT AND BOARD OF TRUSTEES OF THE VILLAGE OF BELLEVUE, PEORIA COUNTY, ILLINOIS, AS FOLLOWS:

Section 1: That the tract of land described on the attached Exhibit A is hereby annexed to and made a part of the Village of Bellevue, in the County of Peoria and the State of Illinois.

Section 2: That the Village Clerk shall file for record in the office of the Recorder of Deeds of Peoria County, Illinois and in the office of the Clerk of Peoria County, Illinois a certified copy of this Ordinance along with a map of the above-described tract of land, a copy of which is attached hereto as Exhibit B.

Section 3: This Ordinance shall be in full force and effect from and after its passage, approval and recordation as provided by law.

PASSED AND APPROVED THIS 22nd DAY OF NOVEMBER, 2004.

5 AYES
0 NAYS
1 ABSENT

VILLAGE OF BELLEVUE, ILLINOIS

By: Ralph E. Wilson
Ralph E. Wilson, President

Attest: Carol S. Howard
Carol S. Howard, Clerk

EXHIBIT A

LEGAL DESCRIPTION

A PART OF THE WEST HALF OF THE SOUTHEAST QUARTER OF SECTION 12, TOWNSHIP 8 NORTH, RANGE 7 EAST OF THE FOURTH PRINCIPAL MERIDIAN, MORE PARTICULARLY BOUNDED AND DESCRIBED AS FOLLOWS, TO-WIT: COMMENCING AT A POINT IN THE SOUTH LINE OF THE SOUTHEAST QUARTER OF SECTION 12 WHICH IS 100 FEET EAST OF THE SOUTHWEST CORNER OF THE SOUTHEAST QUARTER OF SAID SECTION 12 AND RUNNING THENCE EAST 175 FEET; THENCE NORTH 145 FEET; THENCE WEST 175 FEET; THENCE SOUTH 145 FEET TO THE PLACE OF BEGINNING; SITUATED IN THE COUNTY OF PEORIA AND STATE OF ILLINOIS.

P.I.N. NUMBER 17-12-454-001

ADDRESS: 3613 W. LINCOLN AVENUE, PEORIA, IL 61604

ANNEXATION PLAT

A PART OF THE WEST HALF OF THE SOUTHEAST QUARTER OF SECTION 12, TOWNSHIP 8 NORTH, RANGE 7 EAST OF THE 4th PRINCIPAL MERIDIAN, PEORIA COUNTY ILLINOIS

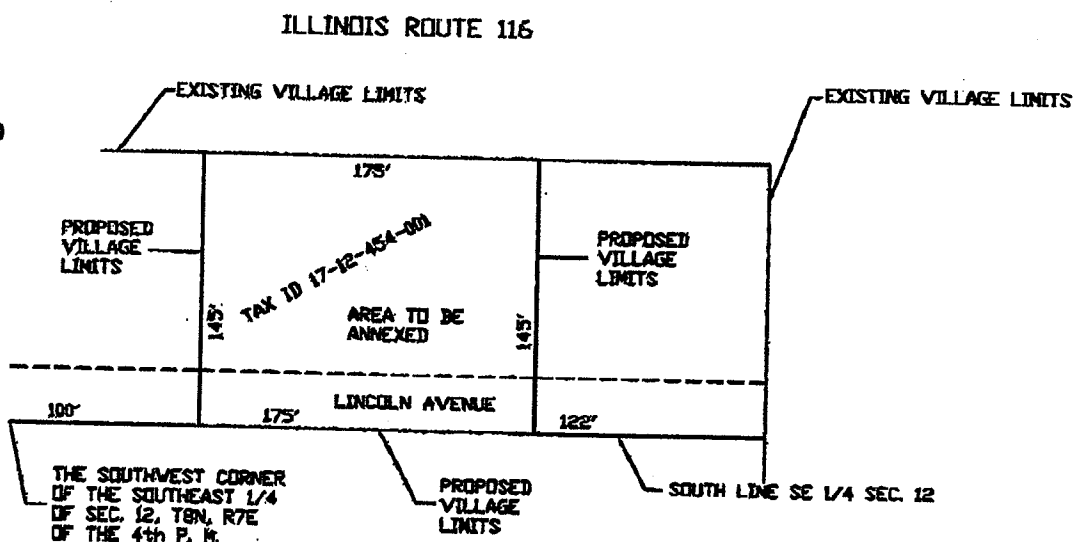
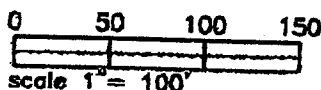
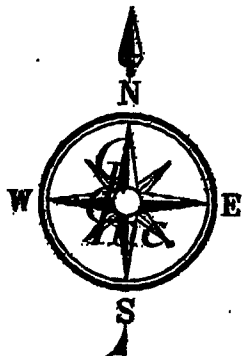

SURVEYOR'S CERTIFICATE

I, David L. Humphrey, Illinois Professional Land Surveyor #2536, do hereby certify that the accompanying Plat correctly represents an area to be annexed to the Village of Bushburn, Woodford County, Illinois



DAVID L. HUMPHREY
I.P.L.S. #2536

Sheet Info:

ANNEXATION PLAT

Village of Bellevue
3613 W. Lincoln Avenue

Remarks:

Drawn By:

dlh

Approved By:

DLH/NAE

Date:

Nov. 1st 2004

Project No.:

10.012

